

Product Range

Butterfly Valve Type 567



**+GF+**

**GEORG FISCHER**  
PIPING SYSTEMS

[www.vyt.com.mx](http://www.vyt.com.mx) , [ventas@vyt.com.mx](mailto:ventas@vyt.com.mx)

# Butterfly valves PP-H

## Butterfly valve type 567 PP-H Bare shaft



### Model:

- Connecting dimension: ISO 7005 PN 10, EN 1092 PN 10, DIN 2501 PN 10, ANSI/ASME B 16.5 Class 150, BS 1560: 1989, BS 4504, JIS B 2220
- Overall length according to EN 558-1, ISO 5752
- Interface F07 for the dimensions DN50-200 according to DIN/ISO 5211
- Interface F10 for the dimensions DN250-300 according to DIN/ISO 5211

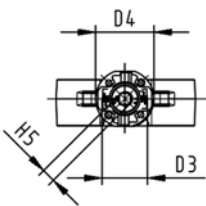
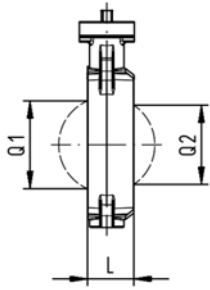
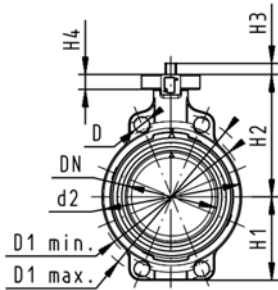

d [mm]	DN [mm]	Inch	PN	kv-value ( $\Delta p=1$ bar) [l/min]	EPDM Code	FPM Code
63	50	2	10	1470	<b>167 567 802</b>	<b>167 567 822</b>
75	65	2 ½	10	2200	<b>167 567 803</b>	<b>167 567 823</b>
90	80	3	10	3000	<b>167 567 804</b>	<b>167 567 824</b>
110	100	4	10	6500	<b>167 567 805</b>	<b>167 567 825</b>
140	125	5	10	11500	<b>167 567 806</b>	<b>167 567 826</b>
160	150	6	10	16600	<b>167 567 807</b>	<b>167 567 827</b>
225	200	8	10	39600	<b>167 567 808</b>	<b>167 567 828</b>
280	250	10	8	55200	<b>167 567 809</b>	<b>167 567 829</b>
315	300	12	8	80000	<b>167 567 810</b>	<b>167 567 830</b>

d [mm]	D [mm]	D1 min. [mm]	D1 max. [mm]	d2 [mm]	D3 [mm]	D4 [mm]	H [mm]	H1 [mm]	H2 [mm]	H3 [mm]	H4 [mm]	H5 [mm]	L [mm]	Q1 [mm]
63	19	120.0	125.0	104	70	90	222	77	134	27	23	11	45	40
75	19	139.7	145.0	115	70	90	235	83	140	27	23	11	46	54
90	19	150.0	160.0	131	70	90	247	89	146	27	23	11	49	67
110	19	175.0	190.5	161	70	90	287	104	167	16	23	14	56	88
140	23	210.0	215.9	187	70	90	313	117	181	16	23	14	64	113
160	24	241.3	241.3	215	70	90	335	130	189	19	23	17	72	139
225	23	290.0	295.0	267	70	90	387	158	210	19	23	17	73	178
280	25	353.0	362.0	329	102	125	509	205	264	40	23	22	113	210
315	25	400.0	432.0	379	102	125	553	228	285	40	23	22	113	256

d [mm]	Q2 [mm]
63	
75	35
90	50
110	74
140	97
160	123
225	169
280	207
315	253



## Butterfly valve type 567 PP-H Hand lever with ratchet settings



### Model:

- Connecting dimension: ISO 7005 PN 10, EN 1092 PN 10, DIN 2501 PN 10, ANSI/ASME B 16.5 Class 150, BS 1560: 1989, BS 4504, JIS B 2220
- Overall length according to EN 558-1, ISO 5752
- We recommend for the dimensions DN250 and DN300 only 6 bar maximum system pressure for the hand lever version

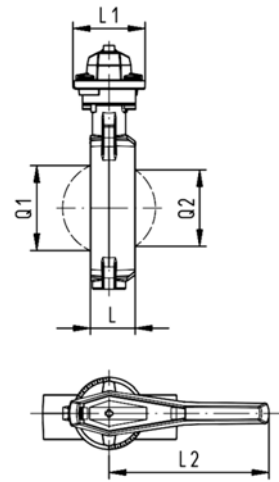
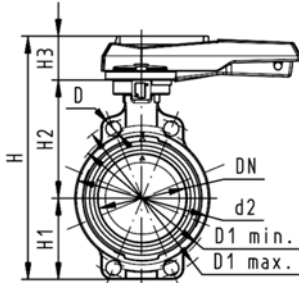

d [mm]	DN [mm]	Inch	PN	kv-value ( $\Delta p=1$ bar) [l/min]	EPDM Code	FPM Code
63	50	2	10	1470	<b>167 567 002</b>	<b>167 567 022</b>
75	65	2 1/2	10	2200	<b>167 567 003</b>	<b>167 567 023</b>
90	80	3	10	3000	<b>167 567 004</b>	<b>167 567 024</b>
110	100	4	10	6500	<b>167 567 005</b>	<b>167 567 025</b>
140	125	5	10	11500	<b>167 567 006</b>	<b>167 567 026</b>
160	150	6	10	16600	<b>167 567 007</b>	<b>167 567 027</b>
225	200	8	10	39600	<b>167 567 008</b>	<b>167 567 028</b>
280	250	10	8	55200	<b>167 567 009</b>	<b>167 567 029</b>
315	300	12	8	80000	<b>167 567 010</b>	<b>167 567 030</b>

d [mm]	D [mm]	D1 min. [mm]	D1 max. [mm]	d2 [mm]	H [mm]	H1 [mm]	H2 [mm]	H3 [mm]	L [mm]	L1 [mm]	L2 [mm]	Q1 [mm]	Q2 [mm]
63	19	120.0	125.0	104	264	77	134	54	45	106	205	40	
75	19	139.7	145.0	115	277	83	140	54	46	106	205	54	35
90	19	150.0	160.0	131	289	89	146	54	49	106	205	67	50
110	19	175.0	190.5	161	325	104	167	55	56	106	255	88	74
140	23	210.0	215.9	187	352	117	181	55	64	106	255	113	97
160	24	241.3	241.3	215	373	130	189	55	72	106	255	139	123
225	23	290.0	295.0	267	435	158	210	67	73	140	408	178	169
280	25	353.0	362.0	329	554	205	264	85	113	149	408	210	207
315	25	400.0	432.0	379	598	228	285	85	113	149	408	256	253



# Butterfly valve type 567 PP-H Reduction gear with handwheel



### Model:

- Connecting dimension: ISO 7005 PN 10, EN 1092 PN 10, DIN 2501 PN 10, ANSI/ASME B 16.5 Class 150, BS 1560: 1989, BS 4504, JIS B 2220
- Overall length according to EN 558-1, ISO 5752

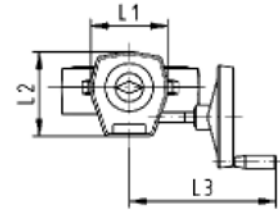
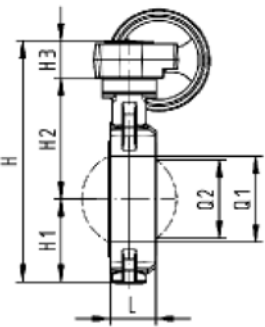
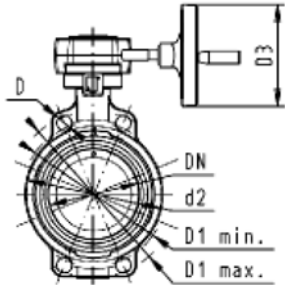

d [mm]	DN [mm]	Inch	PN	kv-value ( $\Delta p=1$ bar) [l/min]	EPDM Code	FPM Code
63	50	2	10	1470	<b>167 567 042</b>	<b>167 567 062</b>
75	65	2 ½	10	2200	<b>167 567 043</b>	<b>167 567 063</b>
90	80	3	10	3000	<b>167 567 044</b>	<b>167 567 064</b>
110	100	4	10	6500	<b>167 567 045</b>	<b>167 567 065</b>
140	125	5	10	11500	<b>167 567 046</b>	<b>167 567 066</b>
160	150	6	10	16600	<b>167 567 047</b>	<b>167 567 067</b>
225	200	8	10	39600	<b>167 567 048</b>	<b>167 567 068</b>
280	250	10	8	55200	<b>167 567 049</b>	<b>167 567 069</b>
315	300	12	8	80000	<b>167 567 050</b>	<b>167 567 070</b>

d [mm]	D [mm]	D1 min. [mm]	D1 max. [mm]	d2 [mm]	D3 [mm]	H [mm]	H1 [mm]	H2 [mm]	H3 [mm]	L [mm]	L1 [mm]	L2 [mm]	L3 [mm]	Q1 [mm]
63	19	120.0	125.0	104	160	278	77	134	60	45	120	132	236	40
75	19	139.7	145.0	115	160	291	83	140	60	46	120	132	236	54
90	19	150.0	160.0	131	160	303	89	146	60	49	120	132	236	67
110	19	175.0	190.5	160	160	339	104	167	60	56	120	132	236	88
140	23	210.0	215.9	187	160	365	117	181	60	64	120	132	236	113
160	24	241.3	241.3	215	160	387	130	189	60	72	120	132	236	139
225	23	290.0	295.0	267	160	436	158	210	60	73	120	132	236	178
280	25	353.0	362.0	329	160	529	205	264	60	113	134	151	261	210
315	25	400.0	432.0	379	160	573	228	285	60	113	134	151	261	256

d [mm]	Q2 [mm]
63	
75	35
90	50
110	74
140	97
160	123
225	169
280	207
315	253

# Butterfly valves PROGEF® SF



## PROGEF® Plus silicone free Butterfly valve type 567 PP-H SF Hand lever with ratchet settings



### Model:

- Silicon-free / paint-compatible
- Connecting dimension: ISO 7005 PN 10, EN 1092 PN 10, DIN 2501 PN 10, ANSI/ASME B 16.5 Class 150, BS 1560: 1989, BS 4504, JIS B 2220
- Overall length according to EN 558-1, ISO 5752

Available from second quarter 2006

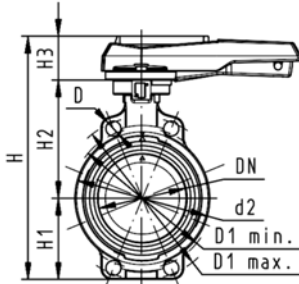

d [mm]	DN [mm]	Inch	PN	kv-value ( $\Delta p=1$ bar) [l/min]	EPDM Code	FPM Code
63	50	2	10	1470	<b>167 567 402</b>	<b>167 567 422</b>
75	65	2 ½	10	2200	<b>167 567 403</b>	<b>167 567 423</b>
90	80	3	10	3000	<b>167 567 404</b>	<b>167 567 424</b>
110	100	4	10	6500	<b>167 567 405</b>	<b>167 567 425</b>
140	125	5	10	11500	<b>167 567 406</b>	<b>167 567 426</b>
160	150	6	10	16600	<b>167 567 407</b>	<b>167 567 427</b>
225	200	8	10	39600	<b>167 567 408</b>	<b>167 567 428</b>

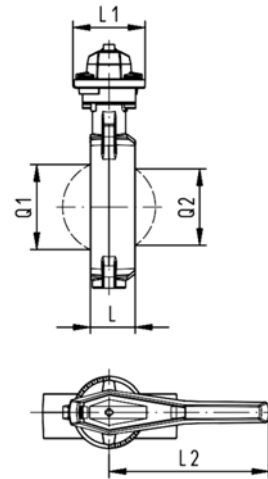

d [mm]	D [mm]	D1 min. [mm]	D1 max. [mm]	d2 [mm]	H [mm]	H1 [mm]	H2 [mm]	H3 [mm]	L [mm]	L1 [mm]	L2 [mm]	Q1 [mm]	Q2 [mm]
63	19	120.0	125.0	104	264	77	134	54	45	106	205	40	
75	19	139.7	145.0	115	277	83	140	54	46	106	205	54	35
90	19	150.0	160.0	131	289	89	146	54	49	106	205	67	50
110	19	175.0	190.5	161	325	104	167	55	56	106	255	88	74
140	23	210.0	215.9	187	352	117	181	55	64	106	255	113	97
160	24	241.3	241.3	215	373	130	189	55	72	106	255	139	123
225	23	290.0	295.0	267	435	158	210	67	73	140	408	178	169

# Butterfly valves electric PP-H

## Butterfly valve type 140 PP-H 100-230V Without manual override



### Model:

- Connecting dimension: ISO 7005 PN 10, EN 1092 PN 10, DIN 2501 PN 10, ANSI/ASME B 16.5 Class 150, BS 1560: 1989, BS 4504, JIS B 2220
- Overall length according to EN 558-1, ISO 5752
- Voltage 100-230 V, 50-60 Hz
- Control time 15 s/90°<) EA31
- Control time 25s/90°<) EA42
- Control range 90°<)
- Actuator with integrated emergency manual override standard
- The dimension DN300 on request

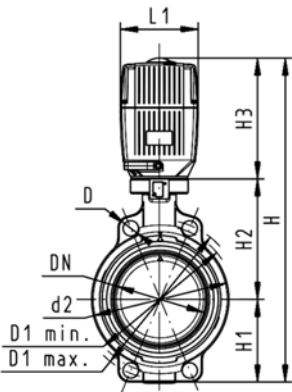

d [mm]	DN [mm]	Inch	PN	kv-value ( $\Delta p=1$ bar) [l/min]	EPDM Code	FPM Code
63	50	2	10	1470	<b>199 140 362</b>	<b>199 140 382</b>
75	65	2 ½	10	2200	<b>199 140 363</b>	<b>199 140 383</b>
90	80	3	10	3000	<b>199 140 364</b>	<b>199 140 384</b>
110	100	4	10	6500	<b>199 140 365</b>	<b>199 140 385</b>
140	125	5	10	11500	<b>199 140 366</b>	<b>199 140 386</b>
160	150	6	10	16600	<b>199 140 367</b>	<b>199 140 387</b>
225	200	8	10	39600	<b>199 140 368</b>	<b>199 140 388</b>
280	250	10	6	55200	<b>199 140 369</b>	<b>199 140 389</b>

d [mm]	Actuator unit type	D [mm]	D1 min. [mm]	D1 max. [mm]	d2 [mm]	H [mm]	H1 [mm]	H2 [mm]	H3 [mm]	L [mm]	L1 [mm]	L2 [mm]	Q1 [mm]
63	EA-31	19	120.0	125.0	104	400	77	134	188	45	122	180	40
75	EA-31	19	139.7	145.0	115	413	83	140	188	46	122	180	54
90	EA-31	19	150.0	160.0	131	428	89	146	188	49	122	180	67
110	EA-31	19	175.0	190.5	161	460	104	167	188	56	122	180	88
140	EA-31	23	210.0	215.9	187	487	117	181	188	64	122	180	113
160	EA-31	24	241.3	241.3	215	508	130	189	188	72	122	180	139
225	EA-42	23	290.0	295.0	267	575	158	210	208	73	122	180	178
280	EA-42	25	353.0	362.0	329	677	205	264	208	113	122	180	256

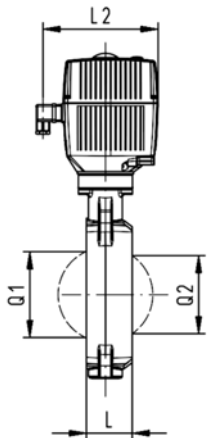

d [mm]	Q2 [mm]
63	
75	35
90	50
110	74
140	97
160	123
225	169
280	207



# Butterfly valve type 140 PP-H 100-230V With manual override



### Model:

- Connecting dimension: ISO 7005 PN 10, EN 1092 PN 10, DIN 2501 PN 10, ANSI/ASME B 16.5 Class 150, BS 1560: 1989, BS 4504, JIS B 2220
- Overall length according to EN 558-1, ISO 5752
- Voltage 100-230 V, 50-60 Hz
- Control time 15 s/90°<) EA31
- Control time 25s/90°<) EA42
- Control range 90°<)
- Actuator with integrated emergency manual override standard

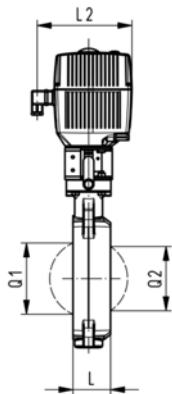
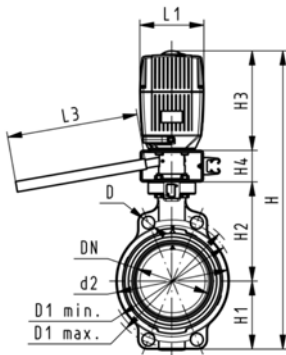

d [mm]	DN [mm]	Inch	PN	kv-value ( $\Delta p=1$ bar) [l/min]	EPDM Code	FPM Code
63	50	2	10	1470	<b>199 140 322</b>	<b>199 140 342</b>
75	65	2 ½	10	2200	<b>199 140 323</b>	<b>199 140 343</b>
90	80	3	10	3000	<b>199 140 324</b>	<b>199 140 344</b>
110	100	4	10	6500	<b>199 140 325</b>	<b>199 140 345</b>
140	125	5	10	11500	<b>199 140 326</b>	<b>199 140 346</b>
160	150	6	10	16600	<b>199 140 327</b>	<b>199 140 347</b>
225	200	8	10	39600	<b>199 140 328</b>	<b>199 140 348</b>

d [mm]	Actuator unit type	D [mm]	D1 min. [mm]	D1 max. [mm]	d2 [mm]	H [mm]	H1 [mm]	H2 [mm]	H3 [mm]	H4 [mm]	L [mm]	L1 [mm]	L2 [mm]
63	EA-31	19	120.0	125.0	104	460	77	134	188	60	45	122	180
75	EA-31	19	139.7	145.0	115	473	83	140	188	60	46	122	180
90	EA-31	19	150.0	160.0	131	488	89	146	188	60	49	122	180
110	EA-31	19	175.0	190.5	161	520	104	167	188	60	56	122	180
140	EA-31	23	210.0	215.9	187	547	117	181	188	60	64	122	180
160	EA-31	24	241.3	241.3	215	568	130	189	188	60	72	122	180
225	EA-42	23	290.0	295.0	267	635	158	210	208	60	73	122	180

d [mm]	L3 [mm]	Q1 [mm]	Q2 [mm]
63	250	40	
75	250	54	35
90	250	67	50
110	250	88	74
140	250	113	97
160	250	139	123
225	250	178	169



## Butterfly valve type 140 PP-H 24V Without manual override



### Model:

- Connecting dimension: ISO 7005 PN 10, EN 1092 PN 10, DIN 2501 PN 10, ANSI/ASME B 16.5 Class 150, BS 1560: 1989, BS 4504, JIS B 2220
- Overall length according to EN 558-1, ISO 5752
- Voltage 24 V AC/DC
- Control time 15 s/90°<) EA31
- Control time 25s/90°<) EA42
- Control range 90°<)
- Actuator with integrated emergency manual override standard
- The dimension DN300 on request

d [mm]	DN [mm]	Inch	PN	kv-value ( $\Delta p=1$ bar) [l/min]	EPDM Code	FPM Code
63	50	2	10	1470	199 140 442	199 140 462
75	65	2 ½	10	2200	199 140 443	199 140 463
90	80	3	10	3000	199 140 444	199 140 464
110	100	4	10	6500	199 140 445	199 140 465
140	125	5	10	11500	199 140 446	199 140 466
160	150	6	10	16600	199 140 447	199 140 467
225	200	8	10	39600	199 140 448	199 140 468
280	250	10	6	55200	199 140 449	199 140 469

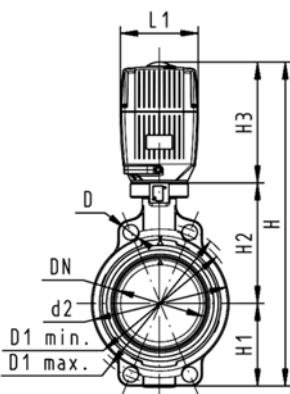

d [mm]	Actuator unit type	D [mm]	D1 min. [mm]	D1 max. [mm]	d2 [mm]	H [mm]	H1 [mm]	H2 [mm]	H3 [mm]	L [mm]	L1 [mm]	L2 [mm]	Q1 [mm]
63	EA-31	19	120.0	125.0	104	400	77	134	188	45	122	180	40
75	EA-31	19	139.7	145.0	115	413	83	140	188	46	122	180	54
90	EA-31	19	150.0	160.0	131	428	89	146	188	49	122	180	67
110	EA-31	19	175.0	190.5	161	460	104	167	188	56	122	180	88
140	EA-31	23	210.0	215.9	187	487	117	181	188	64	122	180	113
160	EA-31	24	241.3	241.3	215	508	130	189	188	72	122	180	139
225	EA-42	23	290.0	295.0	267	575	158	210	208	73	122	180	178
280	EA-42	25	353.0	362.0	329	677	205	264	208	113	122	180	256

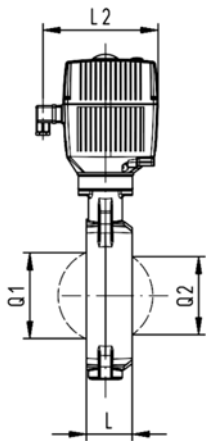

d [mm]	Q2 [mm]
63	
75	35
90	50
110	74
140	97
160	123
225	169
280	207





# Butterfly valve type 140 PP-H 24V With manual override



### Model:

- Connecting dimension: ISO 7005 PN 10, EN 1092 PN 10, DIN 2501 PN 10, ANSI/ASME B 16.5 Class 150, BS 1560: 1989, BS 4504, JIS B 2220
- Overall length according to EN 558-1, ISO 5752
- Voltage 24 V AC/DC
- Control time 15 s/90°<) EA31
- Control time 25s/90°<) EA42
- Control range 90°<)
- Actuator with integrated emergency manual override standard

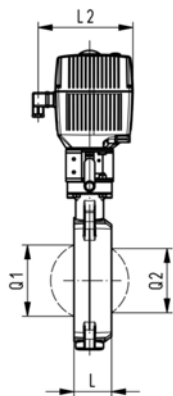
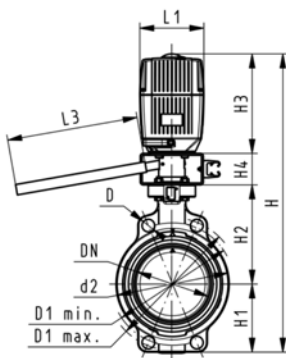

d [mm]	DN [mm]	Inch	PN	kv-value ( $\Delta p=1$ bar) [l/min]	EPDM Code	FPM Code
63	50	2	10	1470	<b>199 140 402</b>	<b>199 140 422</b>
75	65	2 ½	10	2200	<b>199 140 403</b>	<b>199 140 423</b>
90	80	3	10	3000	<b>199 140 404</b>	<b>199 140 424</b>
110	100	4	10	6500	<b>199 140 405</b>	<b>199 140 425</b>
140	125	5	10	11500	<b>199 140 406</b>	<b>199 140 426</b>
160	150	6	10	16600	<b>199 140 407</b>	<b>199 140 427</b>
225	200	8	10	39600	<b>199 140 408</b>	<b>199 140 428</b>

d [mm]	Actuator unit type	D [mm]	D1 min. [mm]	D1 max. [mm]	d2 [mm]	H [mm]	H1 [mm]	H2 [mm]	H3 [mm]	H4 [mm]	L [mm]	L1 [mm]	L2 [mm]
63	EA-31	19	120.0	125.0	104	460	77	134	188	60	45	122	180
75	EA-31	19	139.7	145.0	115	473	83	140	188	60	46	122	180
90	EA-31	19	150.0	160.0	131	488	89	146	188	60	49	122	180
110	EA-31	19	175.0	190.5	161	520	104	167	188	60	56	122	180
140	EA-31	23	210.0	215.9	187	547	117	181	188	60	64	122	180
160	EA-31	24	241.3	241.3	215	568	130	189	188	60	72	122	180
225	EA-42	23	290.0	295.0	267	635	158	210	208	60	73	122	180

d [mm]	L3 [mm]	Q1 [mm]	Q2 [mm]
63	250	40	
75	250	54	35
90	250	67	50
110	250	88	74
140	250	113	97
160	250	139	123
225	250	178	169

# Butterfly valves pneumatic PP-H

## Butterfly valve type 240 PP-H FC (Fail safe to close) Without manual override

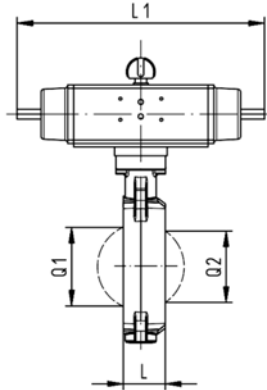
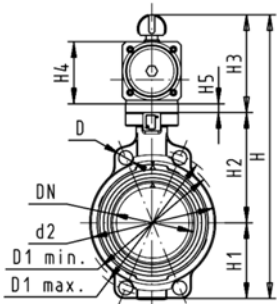

### Model:

- Connecting dimension: ISO 7005 PN 10, EN 1092 PN 10, DIN 2501 PN 10, ANSI/ASME B 16.5 Class 150, BS 1560: 1989, BS 4504, JIS B 2220
- Overall length according to EN 558-1, ISO 5752
- Control range 90°<

d [mm]	DN [mm]	Inch	PN	kv-value ( $\Delta p=1$ bar) [l/min]	EPDM Code	FPM Code
63	50	2	10	1470	<b>199 240 282</b>	<b>199 240 302</b>
75	65	2 ½	10	2200	<b>199 240 283</b>	<b>199 240 303</b>
90	80	3	10	3000	<b>199 240 284</b>	<b>199 240 304</b>
110	100	4	10	6500	<b>199 240 285</b>	<b>199 240 305</b>
140	125	5	10	11500	<b>199 240 286</b>	<b>199 240 306</b>
160	150	6	10	16600	<b>199 240 287</b>	<b>199 240 307</b>
225	200	8	10	39600	<b>199 240 288</b>	<b>199 240 308</b>
280	250	10	8	55200	<b>199 240 289</b>	<b>199 240 309</b>
315	300	12	8	80000	<b>199 240 290</b>	<b>199 240 310</b>

d [mm]	Actuator unit type	D [mm]	D1 min. [mm]	D1 max. [mm]	d2 [mm]	H [mm]	H1 [mm]	H2 [mm]	H3 [mm]	H4 [mm]	H5 [mm]	L [mm]	L1 [mm]
63	PA-30 FC	19	120.0	125.0	104	327	77	134	117	70	15	45	276
75	PA-30 FC	19	139.7	145.0	115	340	83	140	117	70	15	46	276
90	PA-35 FC	19	150.0	160.0	131	361	89	146	126	78	15	49	326
110	PA-40 FC	19	175.0	190.5	161	400	104	167	129	86		56	370
140	PA-45 FC	23	210.0	215.9	187	436	117	181	139	96		64	411
160	PA-50 FC	24	241.3	241.3	215	468	130	189	149	106		72	423
225	PA-55 FC	23	290.0	295.0	267	529	158	210	161	118		73	452
280	PA-65 FC	25	353.0	362.0	329	808	205	264	191	148		113	648
315	PA-70 FC	25	400.0	432.0	379	866	228	285	196	157		113	663

d [mm]	L2 [mm]	Q1 [mm]	Q2 [mm]
63	65	40	
75	65	54	35
90	72	67	50
110	80	88	74
140	90	113	97
160	100	139	123
225	112	178	169
280	137	210	207
315	145	256	253



# Butterfly valve type 240 PP-H FO (Fail safe to open) Without manual override



### Model:

- Connecting dimension: ISO 7005 PN 10, EN 1092 PN 10, DIN 2501 PN 10, ANSI/ASME B 16.5 Class 150, BS 1560: 1989, BS 4504, JIS B 2220
- Overall length according to EN 558-1, ISO 5752
- Control range 90°<

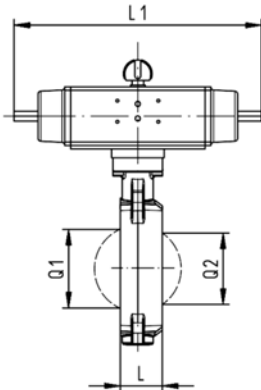
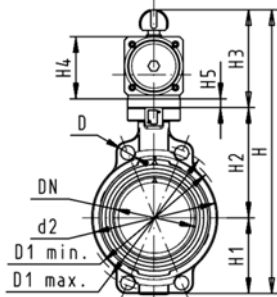

d [mm]	DN [mm]	Inch	PN	kv-value ( $\Delta p=1$ bar) [l/min]	EPDM Code	FPM Code
63	50	2	10	1470	<b>199 240 322</b>	<b>199 240 342</b>
75	65	2 ½	10	2200	<b>199 240 323</b>	<b>199 240 343</b>
90	80	3	10	3000	<b>199 240 324</b>	<b>199 240 344</b>
110	100	4	10	6500	<b>199 240 325</b>	<b>199 240 345</b>
140	125	5	10	11500	<b>199 240 326</b>	<b>199 240 346</b>
160	150	6	10	16600	<b>199 240 327</b>	<b>199 240 347</b>
225	200	8	10	39600	<b>199 240 328</b>	<b>199 240 348</b>
280	250	10	8	55200	<b>199 240 329</b>	<b>199 240 349</b>
315	300	12	8	80000	<b>199 240 330</b>	<b>199 240 350</b>

d [mm]	Actuator unit type	D [mm]	D1 min. [mm]	D1 max. [mm]	d2 [mm]	H [mm]	H1 [mm]	H2 [mm]	H3 [mm]	H4 [mm]	H5 [mm]	L [mm]	L1 [mm]
63	PA-30 FO	19	120.0	125.0	104	327	77	134	117	70	15	45	276
75	PA-30 FO	19	139.7	145.0	115	340	83	140	117	70	15	46	276
90	PA-35 FO	19	150.0	160.0	131	361	89	146	126	78	15	49	326
110	PA-40 FO	19	175.0	190.5	161	400	104	167	129	86		56	370
140	PA-45 FO	23	210.0	215.9	187	436	117	181	139	96		64	411
160	PA-50 FO	24	241.3	241.3	215	468	130	189	149	106		72	423
225	PA-55 FO	23	290.0	295.0	267	529	158	210	161	118		73	452
280	PA-65 FO	25	353.0	362.0	329	808	205	264	191	148		113	648
315	PA-70 FO	25	400.0	432.0	379	866	228	285	196	157		113	663

d [mm]	L2 [mm]	Q1 [mm]	Q2 [mm]
63	65	40	
75	65	54	35
90	72	67	50
110	80	88	74
140	90	113	97
160	100	139	123
225	112	178	169
280	137	210	207
315	145	256	253



# Butterfly valve type 240 PP-H DA (Double acting) Without manual override



## Model:

- Connecting dimension: ISO 7005 PN 10, EN 1092 PN 10, DIN 2501 PN 10, ANSI/ASME B 16.5 Class 150, BS 1560: 1989, BS 4504, JIS B 2220
- Overall length according to EN 558-1, ISO 5752
- Control range 90°<

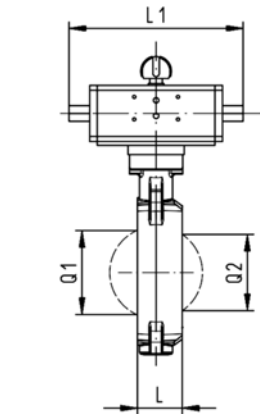
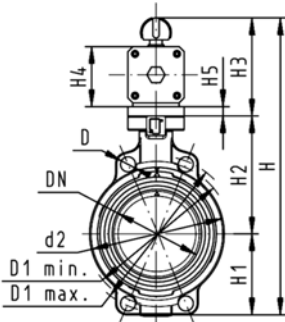

d [mm]	DN [mm]	Inch	PN	kv-value ( $\Delta p=1$ bar) [l/min]	EPDM Code	FPM Code
63	50	2	10	1470	<b>199 240 362</b>	<b>199 240 382</b>
75	65	2 ½	10	2200	<b>199 240 363</b>	<b>199 240 383</b>
90	80	3	10	3000	<b>199 240 364</b>	<b>199 240 384</b>
110	100	4	10	6500	<b>199 240 365</b>	<b>199 240 385</b>
140	125	5	10	11500	<b>199 240 366</b>	<b>199 240 386</b>
160	150	6	10	16600	<b>199 240 367</b>	<b>199 240 387</b>
225	200	8	10	39600	<b>199 240 368</b>	<b>199 240 388</b>
280	250	10	8	55200	<b>199 240 369</b>	<b>199 240 389</b>
315	300	12	8	80000	<b>199 240 370</b>	<b>199 240 390</b>

d [mm]	Actuator unit type	D [mm]	D1 min. [mm]	D1 max. [mm]	d2 [mm]	H [mm]	H1 [mm]	H2 [mm]	H3 [mm]	H4 [mm]	H5 [mm]	L [mm]	L1 [mm]
63	PA-35 DA	19	120.0	125.0	104	317	77	134	107	60	15	45	177
75	PA-35 DA	19	139.7	145.0	115	330	83	140	107	60	15	46	177
90	PA-40 DA	19	150.0	160.0	131	348	89	146	113	66	15	49	190
110	PA-45 DA	19	175.0	190.5	161	372	104	167	102	71		56	235
140	PA-45 DA	23	210.0	215.9	187	408	117	181	111	78		64	235
160	PA-55 DA	24	241.3	241.3	215	448	130	189	129	86		72	279
225	PA-55 DA	23	290.0	295.0	267	507	158	210	139	96		73	279
280	PA-65 DA	25	353.0	362.0	329	748	205	264	161	118		113	350
315	PA-70 DA	25	400.0	432.0	379	816	228	285	173	130		113	381

d [mm]	L2 [mm]	Q1 [mm]	Q2 [mm]
63	55	40	
75	55	54	35
90	60	67	50
110	65	88	74
140	72	113	97
160	80	139	123
225	90	178	169
280	112	210	207
315	125	256	253