

Product Range

Butterfly Valve Type 567



Butterfly valves PVC-C

Butterfly valve type 567 PVC-C Bare shaft



Model:

- Connecting dimension: ISO 7005 PN 10, EN 1092 PN 10, DIN 2501 PN 10, ANSI/ASME B 16.5 Class 150, BS 1560: 1989, BS 4504, JIS B 2220
- Overall length according to EN 558-1, ISO 5752
- Interface F07 according to DIN/ISO 5211

* Available on request

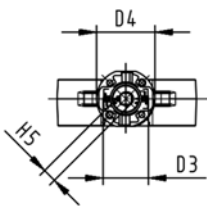
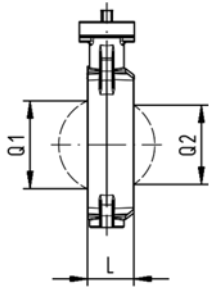
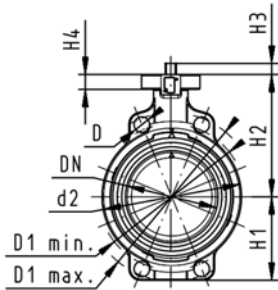

d [mm]	DN [mm]	Inch	PN	kv-value ($\Delta p=1$ bar) [l/min]	EPDM Code	FPM Code
*63	50	2	10	1470	163 567 802	163 567 822
75	65	2 ½	10	2200	163 567 803	163 567 823
90	80	3	10	3000	163 567 804	163 567 824
110	100	4	10	6500	163 567 805	163 567 825
*140	125	5	10	11500	163 567 806	163 567 826
160	150	6	10	16600	163 567 807	163 567 827
225	200	8	10	39600	163 567 808	163 567 828

d [mm]	D [mm]	D1 min. [mm]	D1 max. [mm]	d2 [mm]	D3 [mm]	D4 [mm]	H [mm]	H1 [mm]	H2 [mm]	H3 [mm]	H4 [mm]	H5 [mm]	L [mm]	Q1 [mm]
*63	19	120.0	125.0	104	70	90	222	77	134	27	23	11	45	40
75	19	139.7	145.0	115	70	90	235	83	140	27	23	11	46	54
90	19	150.0	160.0	131	70	90	247	89	146	27	23	11	49	67
110	19	175.0	190.5	161	70	90	287	104	167	16	23	14	56	88
*140	23	210.0	215.9	187	70	90	313	117	181	16	23	14	64	113
160	24	241.3	241.3	215	70	90	335	130	189	19	23	17	72	139
225	23	290.0	295.0	267	70	90	387	158	210	19	23	17	73	178

d [mm]	Q2 [mm]
*63	
75	35
90	50
110	74
*140	97
160	123
225	169



Butterfly valve type 567 PVC-C Hand lever with ratchet settings



Model:

- Connecting dimension: ISO 7005 PN 10, EN 1092 PN 10, DIN 2501 PN 10, ANSI/ASME B 16.5 Class 150, BS 1560: 1989, BS 4504, JIS B 2220
- Overall length according to EN 558-1, ISO 5752

* Available on request

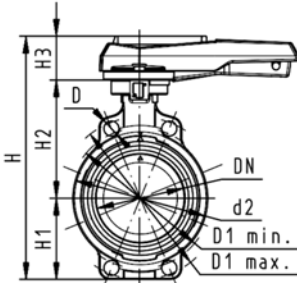

d [mm]	DN [mm]	Inch	PN	kv-value ($\Delta p=1$ bar) [l/min]	EPDM Code	FPM Code
*63	50	2	10	1470	163 567 002	163 567 022
75	65	2 ½	10	2200	163 567 003	163 567 023
90	80	3	10	3000	163 567 004	163 567 024
110	100	4	10	6500	163 567 005	163 567 025
*140	125	5	10	11500	163 567 006	163 567 026
160	150	6	10	16600	163 567 007	163 567 027
225	200	8	10	39600	163 567 008	163 567 028

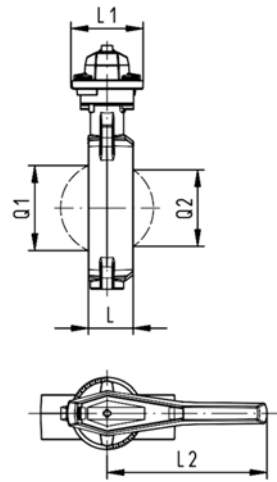

d [mm]	D [mm]	D1 min. [mm]	D1 max. [mm]	d2 [mm]	H [mm]	H1 [mm]	H2 [mm]	H3 [mm]	L [mm]	L1 [mm]	L2 [mm]	Q1 [mm]	Q2 [mm]
*63	19	120.0	125.0	104	264	77	134	54	45	106	205	40	
75	19	139.7	145.0	115	277	83	140	54	46	106	205	54	35
90	19	150.0	160.0	131	289	89	146	54	49	106	205	67	50
110	19	175.0	190.5	161	325	104	167	55	56	106	255	88	74
*140	23	210.0	215.9	187	352	117	181	55	64	106	255	113	97
160	24	241.3	241.3	215	373	130	189	55	72	106	255	139	123
225	23	290.0	295.0	267	435	158	210	67	73	140	408	178	169



Butterfly valve type 567 PVC-C Reduction gear with handwheel



Model:

- Connecting dimension: ISO 7005 PN 10, EN 1092 PN 10, DIN 2501 PN 10, ANSI/ASME B 16.5 Class 150, BS 1560: 1989, BS 4504, JIS B 2220
- Overall length according to EN 558-1, ISO 5752

* Available on request

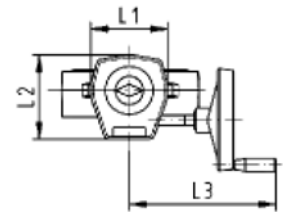
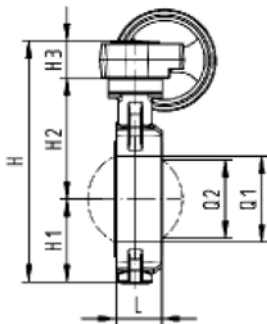
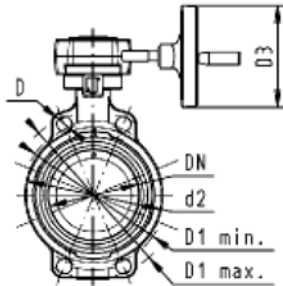

d [mm]	DN [mm]	Inch	PN	kv-value ($\Delta p=1$ bar) [l/min]	EPDM Code	FPM Code
*63	50	2	10	1470	163 567 042	163 567 062
75	65	2 ½	10	2200	163 567 043	163 567 063
90	80	3	10	3000	163 567 044	163 567 064
110	100	4	10	6500	163 567 045	163 567 065
*140	125	5	10	11500	163 567 046	163 567 066
160	150	6	10	16600	163 567 047	163 567 067
225	200	8	10	39600	163 567 048	163 567 068

d [mm]	D [mm]	D1 min. [mm]	D1 max. [mm]	d2 [mm]	D3 [mm]	H [mm]	H1 [mm]	H2 [mm]	H3 [mm]	L [mm]	L1 [mm]	L2 [mm]	L3 [mm]
*63	19	120.0	125.0	104	160	278	77	134	60	45	120	132	236
75	19	139.7	145.0	115	160	291	83	140	60	46	120	132	236
90	19	150.0	160.0	131	160	303	89	146	60	49	120	132	236
110	19	175.0	190.5	160	160	339	104	167	60	56	120	132	236
*140	23	210.0	215.9	187	160	365	117	181	60	64	120	132	236
160	24	241.3	241.3	215	160	387	130	189	60	72	120	132	236
225	23	290.0	295.0	267	160	436	158	210	60	73	120	132	236

d [mm]	Q1 [mm]	Q2 [mm]
*63	40	
75	54	35
90	67	50
110	88	74
*140	113	97
160	139	123
225	178	169

Butterfly valves electric PVC-C

Butterfly valve type 140 PVC-C 100-230V Without manual override



Model:

- Connecting dimension: ISO 7005 PN 10, EN 1092 PN 10, DIN 2501 PN 10, ANSI/ASME B 16.5 Class 150, BS 1560: 1989, BS 4504, JIS B 2220
- Overall length according to EN 558-1, ISO 5752
- Voltage 100-230 V, 50-60 Hz
- Control time 15 s/90°<) EA31
- Control time 25s/90°<) EA42
- Control range 90°<)
- Actuator with integrated emergency manual override standard

* Available on request

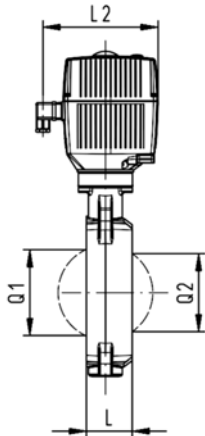
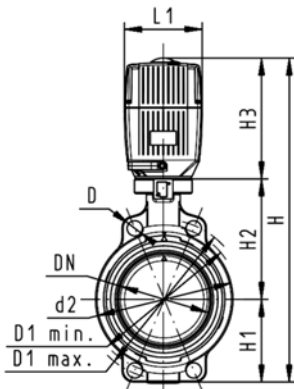

d [mm]	DN [mm]	Inch	PN	kv-value ($\Delta p=1$ bar) [l/min]	EPDM Code	FPM Code
*63	50	2	10	1470	199 140 202	199 140 222
75	65	2 ½	10	2200	199 140 203	199 140 223
90	80	3	10	3000	199 140 204	199 140 224
110	100	4	10	6500	199 140 205	199 140 225
*140	125	5	10	11500	199 140 206	199 140 226
160	150	6	10	16600	199 140 207	199 140 227
225	200	8	10	39600	199 140 208	199 140 228

d [mm]	Actuator unit type	D [mm]	D1 min. [mm]	D1 max. [mm]	d2 [mm]	H [mm]	H1 [mm]	H2 [mm]	H3 [mm]	L [mm]	L1 [mm]	L2 [mm]
*63	EA-31	19	120.0	125.0	104	400	77	134	188	45	122	180
75	EA-31	19	139.7	145.0	115	413	83	140	188	46	122	180
90	EA-31	19	150.0	160.0	131	428	89	146	188	49	122	180
110	EA-31	19	175.0	190.5	161	460	104	167	188	56	122	180
*140	EA-31	23	210.0	215.9	187	487	117	181	188	64	122	180
160	EA-31	24	241.3	241.3	215	508	130	189	188	72	122	180
225	EA-42	23	290.0	295.0	267	575	158	210	208	73	122	180

d [mm]	Q1 [mm]	Q2 [mm]
*63	40	
75	54	35
90	67	50
110	88	74
*140	113	97
160	139	123
225	178	169



Butterfly valve type 140 PVC-C 100-230V With manual override



Model:

- Connecting dimension: ISO 7005 PN 10, EN 1092 PN 10, DIN 2501 PN 10, ANSI/ASME B 16.5 Class 150, BS 1560: 1989, BS 4504, JIS B 2220
- Overall length according to EN 558-1, ISO 5752
- Voltage 100-230 V, 50-60 Hz
- Control time 15 s/90°<) EA31
- Control time 25s/90°<) EA42
- Control range 90°<)
- Actuator with integrated emergency manual override standard

* Available on request

d [mm]	DN [mm]	Inch	PN	kv-value ($\Delta p=1$ bar) [l/min]	EPDM Code	FPM Code
*63	50	2	10	1470	199 140 162	199 140 182
75	65	2 ½	10	2200	199 140 163	199 140 183
90	80	3	10	3000	199 140 164	199 140 184
110	100	4	10	6500	199 140 165	199 140 185
*140	125	5	10	11500	199 140 166	199 140 186
160	150	6	10	16600	199 140 167	199 140 187
225	200	8	10	39600	199 140 168	199 140 188

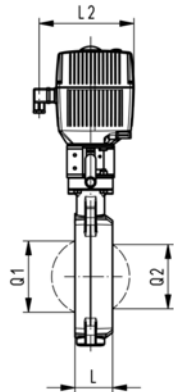
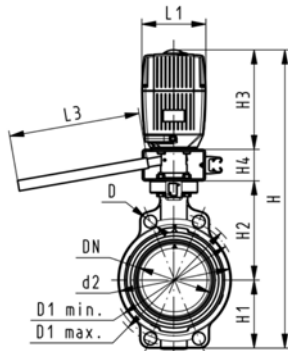

d [mm]	Actuator unit type	D [mm]	D1 min. [mm]	D1 max. [mm]	d2 [mm]	H [mm]	H1 [mm]	H2 [mm]	H3 [mm]	H4 [mm]	L [mm]	L1 [mm]
*63	EA-31	19	120.0	125.0	104	460	77	134	188	60	45	122
75	EA-31	19	139.7	145.0	115	473	83	140	188	60	46	122
90	EA-31	19	150.0	160.0	131	488	89	146	188	60	49	122
110	EA-31	19	175.0	190.5	161	520	104	167	188	60	56	122
*140	EA-31	23	210.0	215.9	187	547	117	181	188	60	64	122
160	EA-31	24	241.3	241.3	215	568	130	189	188	60	72	122
225	EA-42	23	290.0	295.0	267	635	158	210	208	60	73	122

d [mm]	L2 [mm]	L3 [mm]	Q1 [mm]	Q2 [mm]
*63	180	250	40	
75	180	250	54	35
90	180	250	67	50
110	180	250	88	74
*140	180	250	113	97
160	180	250	139	123
225	180	250	178	169



Butterfly valve type 140 PVC-C 24V Without manual override



Model:

- Connecting dimension: ISO 7005 PN 10, EN 1092 PN 10, DIN 2501 PN 10, ANSI/ASME B 16.5 Class 150, BS 1560: 1989, BS 4504, JIS B 2220
- Overall length according to EN 558-1, ISO 5752
- Voltage 24 V AC/DC
- Control time 15 s/90°<) EA31
- Control time 25s/90°<) EA42
- Control range 90°<)
- Actuator with integrated emergency manual override standard

* Available on request

d [mm]	DN [mm]	Inch	PN	kv-value ($\Delta p=1$ bar) [l/min]	EPDM Code	FPM Code
*63	50	2	10	1470	199 140 282	199 140 302
75	65	2 ½	10	2200	199 140 283	199 140 303
90	80	3	10	3000	199 140 284	199 140 304
110	100	4	10	6500	199 140 285	199 140 305
*140	125	5	10	11500	199 140 286	199 140 306
160	150	6	10	16600	199 140 287	199 140 307
225	200	8	10	39600	199 140 288	199 140 308

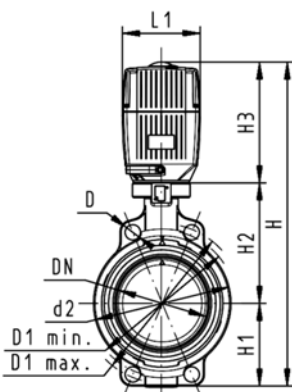

d [mm]	Actuator unit type	D [mm]	D1 min. [mm]	D1 max. [mm]	d2 [mm]	H [mm]	H1 [mm]	H2 [mm]	H3 [mm]	L [mm]	L1 [mm]	L2 [mm]
*63	EA-31	19	120.0	125.0	104	400	77	134	188	45	122	180
75	EA-31	19	139.7	145.0	115	413	83	140	188	46	122	180
90	EA-31	19	150.0	160.0	131	428	89	146	188	49	122	180
110	EA-31	19	175.0	190.5	161	460	104	167	188	56	122	180
*140	EA-31	23	210.0	215.9	187	487	117	181	188	64	122	180
160	EA-31	24	241.3	241.3	215	508	130	189	188	72	122	180
225	EA-42	23	290.0	295.0	267	575	158	210	208	73	122	180

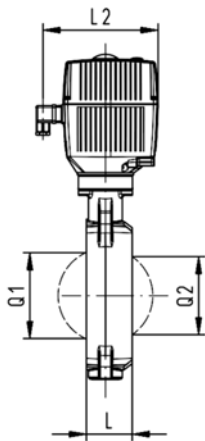

d [mm]	Q1 [mm]	Q2 [mm]
*63	40	
75	54	35
90	67	50
110	88	74
*140	113	97
160	139	123
225	178	169



Butterfly valve type 140 PVC-C 24V With manual override



Model:

- Connecting dimension: ISO 7005 PN 10, EN 1092 PN 10, DIN 2501 PN 10, ANSI/ASME B 16.5 Class 150, BS 1560: 1989, BS 4504, JIS B 2220
- Overall length according to EN 558-1, ISO 5752
- Voltage 24 V AC/DC
- Control time 15 s/90°<) EA31
- Control time 25s/90°<) EA42
- Control range 90°<)
- Actuator with integrated emergency manual override standard

* Available on request

d [mm]	DN [mm]	Inch	PN	kv-value ($\Delta p=1$ bar) [l/min]	EPDM Code	FPM Code
*63	50	2	10	1470	199 140 242	199 140 262
75	65	2 1/2	10	2200	199 140 243	199 140 263
90	80	3	10	3000	199 140 244	199 140 264
110	100	4	10	6500	199 140 245	199 140 265
*140	125	5	10	11500	199 140 246	199 140 266
160	150	6	10	16600	199 140 247	199 140 267
225	200	8	10	39600	199 140 248	199 140 268

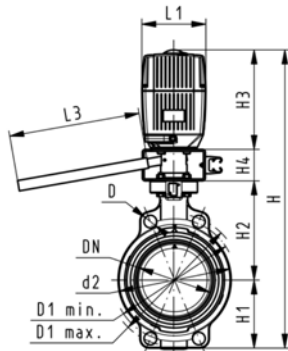

d [mm]	Actuator unit type	D [mm]	D1 min. [mm]	D1 max. [mm]	d2 [mm]	H [mm]	H1 [mm]	H2 [mm]	H3 [mm]	H4 [mm]	L [mm]	L1 [mm]
*63	EA-31	19	120.0	125.0	104	460	77	134	188	60	45	122
75	EA-31	19	139.7	145.0	115	473	83	140	188	60	46	122
90	EA-31	19	150.0	160.0	131	488	89	146	188	60	49	122
110	EA-31	19	175.0	190.5	161	520	104	167	188	60	56	122
*140	EA-31	23	210.0	215.9	187	547	117	181	188	60	64	122
160	EA-31	24	241.3	241.3	215	568	130	189	188	60	72	122
225	EA-42	23	290.0	295.0	267	635	158	210	208	60	73	122

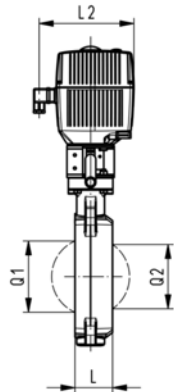

d [mm]	L2 [mm]	L3 [mm]	Q1 [mm]	Q2 [mm]
*63	180	250	40	
75	180	250	54	35
90	180	250	67	50
110	180	250	88	74
*140	180	250	113	97
160	180	250	139	123
225	180	250	178	169

Butterfly valves pneumatic PVC-C

Butterfly valve type 240 PVC-C FC (Fail safe to close) Without manual override

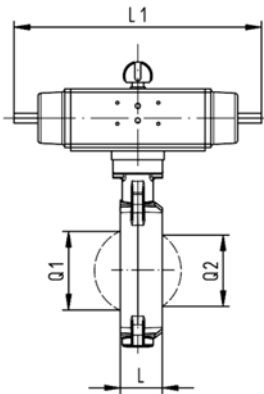
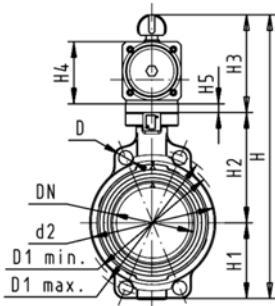

Model:

- Connecting dimension: ISO 7005 PN 10, EN 1092 PN 10, DIN 2501 PN 10, ANSI/ASME B 16.5 Class 150, BS 1560: 1989, BS 4504, JIS B 2220
- Overall length according to EN 558-1, ISO 5752
- Control range 90°<

* Available on request

d [mm]	DN [mm]	Inch	PN	kv-value ($\Delta p=1$ bar) [l/min]	EPDM Code	FPM Code
*63	50	2	10	1470	199 240 162	199 240 182
75	65	2 ½	10	2200	199 240 163	199 240 183
90	80	3	10	3000	199 240 164	199 240 184
110	100	4	10	6500	199 240 165	199 240 185
*140	125	5	10	11500	199 240 166	199 240 186
160	150	6	10	16600	199 240 167	199 240 187
225	200	8	10	39600	199 240 168	199 240 188

d [mm]	Actuator unit type	D [mm]	D1 min. [mm]	D1 max. [mm]	d2 [mm]	H [mm]	H1 [mm]	H2 [mm]	H3 [mm]	H4 [mm]	H5 [mm]	L [mm]
*63	PA-30 FC	19	120.0	125.0	104	327	77	134	117	70	15	45
75	PA-30 FC	19	139.7	145.0	115	340	83	140	117	70	15	46
90	PA-35 FC	19	150.0	160.0	131	361	89	146	126	78	15	49
110	PA-40 FC	19	175.0	190.5	161	400	104	167	129	86		56
*140	PA-45 FC	23	210.0	215.9	187	436	117	181	139	96		64
160	PA-50 FC	24	241.3	241.3	215	468	130	189	149	106		72
225	PA-55 FC	23	290.0	295.0	267	529	158	210	161	118		73

d [mm]	L1 [mm]	L2 [mm]	Q1 [mm]	Q2 [mm]
*63	276	65	40	
75	276	65	54	35
90	326	72	67	50
110	370	80	88	74
*140	411	90	113	97
160	423	100	139	123
225	452	112	178	169



Butterfly valve type 240 PVC-C FO (Fail safe to open) Without manual override



Model:

- Connecting dimension: ISO 7005 PN 10, EN 1092 PN 10, DIN 2501 PN 10, ANSI/ASME B 16.5 Class 150, BS 1560: 1989, BS 4504, JIS B 2220
- Overall length according to EN 558-1, ISO 5752
- Control range 90°<

* Available on request

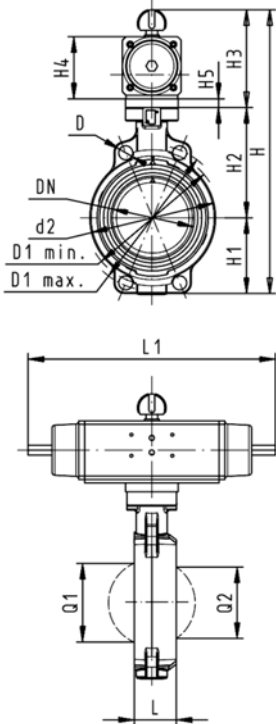

d [mm]	DN [mm]	Inch	PN	kv-value ($\Delta p=1$ bar) [l/min]	EPDM Code	FPM Code
*63	50	2	10	1470	199 240 202	199 240 222
75	65	2 ½	10	2200	199 240 203	199 240 223
90	80	3	10	3000	199 240 204	199 240 224
110	100	4	10	6500	199 240 205	199 240 225
*140	125	5	10	11500	199 240 206	199 240 226
160	150	6	10	16600	199 240 207	199 240 227
225	200	8	10	39600	199 240 208	199 240 228

d [mm]	Actuator unit type	D [mm]	D1 min. [mm]	D1 max. [mm]	d2 [mm]	H [mm]	H1 [mm]	H2 [mm]	H3 [mm]	H4 [mm]	H5 [mm]	L [mm]
*63	PA-30 FO	19	120.0	125.0	104	327	77	134	117	70	15	45
75	PA-30 FO	19	139.7	145.0	115	340	83	140	117	70	15	46
90	PA-35 FO	19	150.0	160.0	131	361	89	146	126	78	15	49
110	PA-40 FO	19	175.0	190.5	161	400	104	167	129	86		56
*140	PA-45 FO	23	210.0	215.9	187	436	117	181	139	96		64
160	PA-50 FO	24	241.3	241.3	215	468	130	189	149	106		72
225	PA-55 FO	23	290.0	295.0	267	529	158	210	161	118		73

d [mm]	L1 [mm]	L2 [mm]	Q1 [mm]	Q2 [mm]
*63	276	65	40	
75	276	65	54	35
90	326	72	67	50
110	370	80	88	74
*140	411	90	113	97
160	423	100	139	123
225	452	112	178	169



Butterfly valve type 240 PVC-C DA (Double acting) Without manual override



Model:

- Connecting dimension: ISO 7005 PN 10, EN 1092 PN 10, DIN 2501 PN 10, ANSI/ASME B 16.5 Class 150, BS 1560: 1989, BS 4504, JIS B 2220
- Overall length according to EN 558-1, ISO 5752
- Control range 90°<

* Available on request

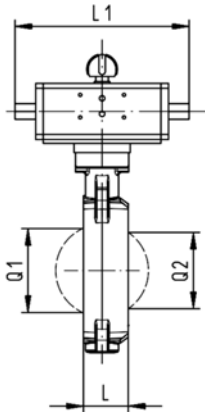
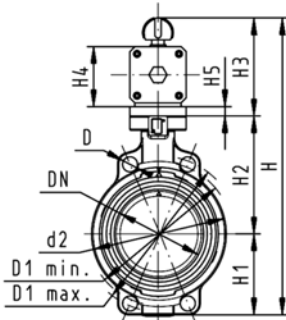

d [mm]	DN [mm]	Inch	PN	kv-value ($\Delta p=1$ bar) [l/min]	EPDM Code	FPM Code
*63	50	2	10	1470	199 240 242	199 240 262
75	65	2 ½	10	2200	199 240 243	199 240 263
90	80	3	10	3000	199 240 244	199 240 264
110	100	4	10	6500	199 240 245	199 240 265
*140	125	5	10	11500	199 240 246	199 240 266
160	150	6	10	16600	199 240 247	199 240 267
225	200	8	10	39600	199 240 248	199 240 268

d [mm]	Actuator unit type	D [mm]	D1 min. [mm]	D1 max. [mm]	d2 [mm]	H [mm]	H1 [mm]	H2 [mm]	H3 [mm]	H4 [mm]	H5 [mm]	L [mm]
*63	PA-35 DA	19	120.0	125.0	104	317	77	134	107	60	15	45
75	PA-35 DA	19	139.7	145.0	115	330	83	140	107	60	15	46
90	PA-40 DA	19	150.0	160.0	131	348	89	146	113	66	15	49
110	PA-45 DA	19	175.0	190.5	161	372	104	167	102	71		56
*140	PA-45 DA	23	210.0	215.9	187	408	117	181	111	78		64
160	PA-55 DA	24	241.3	241.3	215	448	130	189	129	86		72
225	PA-55 DA	23	290.0	295.0	267	507	158	210	139	96		73

d [mm]	L1 [mm]	L2 [mm]	Q1 [mm]	Q2 [mm]
*63	177	55	40	
75	177	55	54	35
90	190	60	67	50
110	235	65	88	74
*140	235	72	113	97
160	279	80	139	123
225	279	90	178	169